

LEGEND

- 92.30 EXISTING TOPO GRADE
- × 92.90 PROPOSED GRADE
- EXISTING GRADE
- STORM SEWER
- SANITARY SEWER
- X— WATERMAIN
- X— BELL UNDERGROUND
- X— GAS UNDERGROUND
- X— CABLE UNDERGROUND
- X— ELECTRICAL UNDERGROUND
- BH ○ LS ○ H OVERHEAD UTILITIES
- UTILITY POLE
- AN UTILITY ANCOR
- UTILITY PEDISTAL
- PROPERTY BAR FOUND
- ▬ RS ROAD SIGN
- ▬ FENCE
- ☼ TREELINE
- ☼ TREE
- 11.58 N49°15'50"E PROPERTY BOUNDARY
- ▨ EXISTING BUILDING
- ▨ EXISTING BUILDING TO BE REMOVED
- ▨ PROPOSED BUILDING

GENERAL NOTES

- ALL WORK ON TOWN PROPERTY TO BE PERFORMED BY A CONTRACTOR APPROVED BY THE TOWN.
- CONTRACTOR TO VERIFY ALL DIMENSIONS AND ELEVATIONS PRIOR TO THE START OF CONSTRUCTION.
- CONTRACTOR TO OBTAIN ALL NECESSARY PERMITS PRIOR TO START OF CONSTRUCTION.

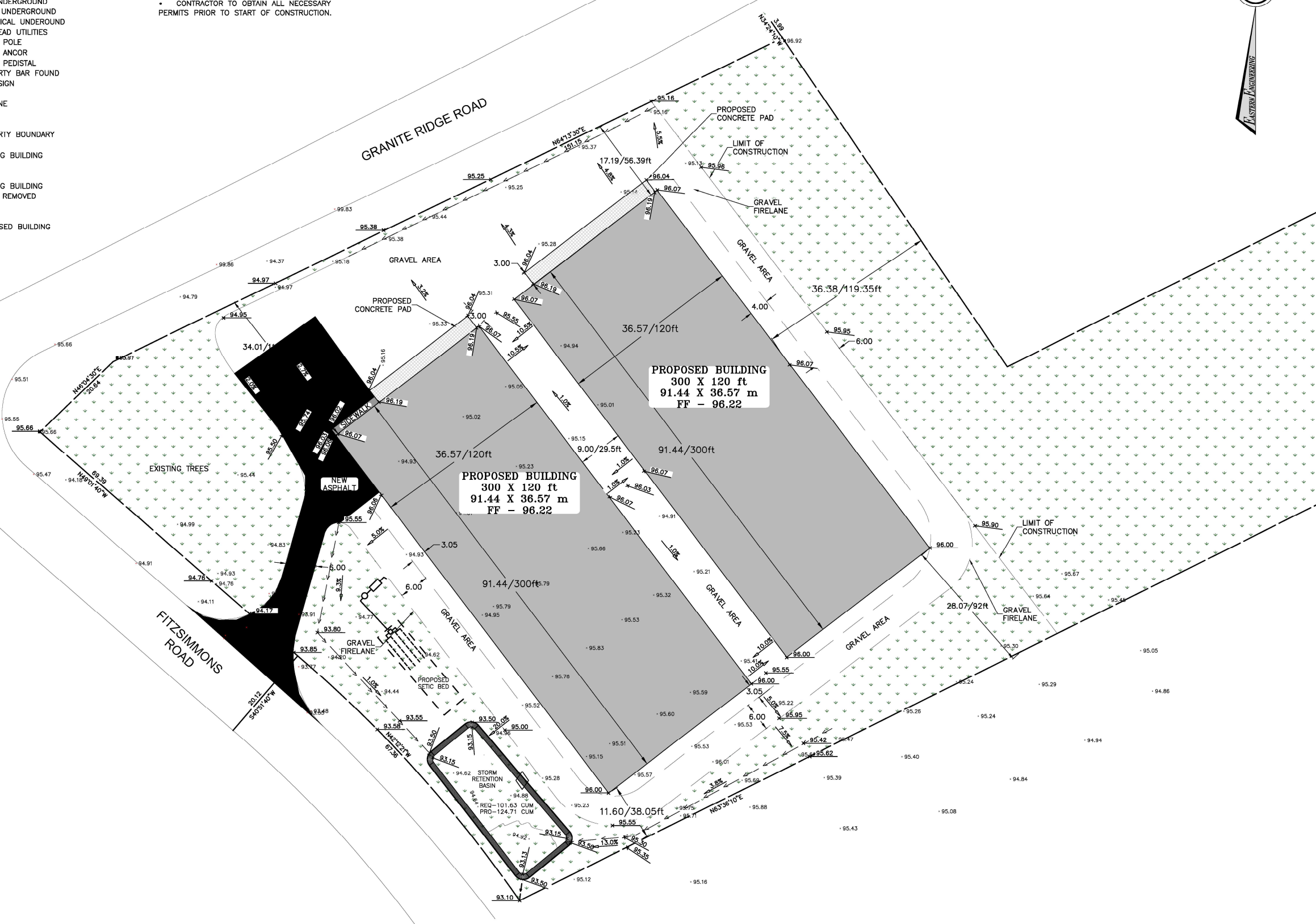
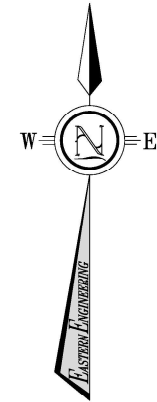

BENCHMARK

NOTE:
CONTRACTOR TO CONTACT UTILITY COMPANIES TO DETERMINE TYPE, LOCATION, AND CONFIGURATION OF EXISTING PLANT.

No.	By	Date	Revisions

All drawings, specifications and related documents are the copyright property of the Engineer and must be returned upon request. Reproduction of drawings, specifications, and related documents in part or whole is forbidden without the Engineers' written permission.

The contractor must check and verify all dimensions on the job prior to start of construction.

Drawings are not to be scaled.

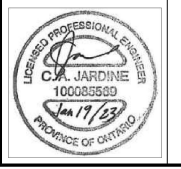

EASTERN ENGINEERING GROUP INC.
CONSULTING ENGINEERS

Apex Building Telephone: (613) 345-0400
207 - 100 Strowger Blvd. Fax: (613) 345-0008
Brockville, Ont. K6V 5J9 www.EastEng.com

PECK'S MARINA BOAT STORAGE

GRADING AND DRAINAGE PLAN

Design: HS	Checked: CAJ	Approved: CAJ	Project No.: 10055
Drawn: HS	Checked: CAJ	Date: 2023-01-23	Contract No.:

Scale: Horizontal: 400

C1

File No.: 10055 C.dwg

Z:\Current\Projects\10055\Peck Marina Boat Storage\WIP\10055_C.dwg

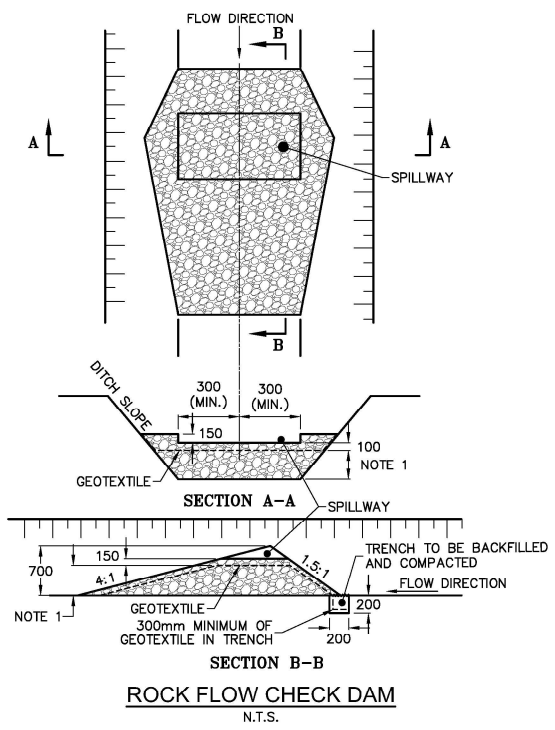

ROCK FLOW CHECK DAM
N.T.S.

NOTES:
1. REAR YARD DITCHES - 300mm
OUTLET DITCH - 400mm

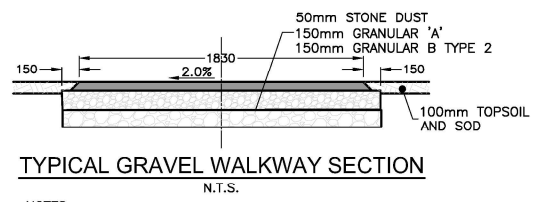

TYPICAL GRAVEL WALKWAY SECTION
N.T.S.

NOTES:
1. EDGES OF STONE DUST TO BE TAMPED ON A 45° ANGLE.
2. TIE IN TOPSOIL AND SEED TO MATCH EXISTING.

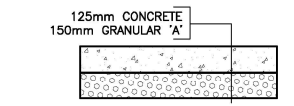

TYPICAL CONCRETE SIDEWALK
N.T.S.

NOTE:
CONCRETE TO BE 30MPa, 7.0% ± 1.5% AIR CONTENT, SLUMP 70mm ± 20mm.

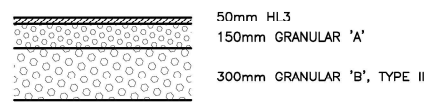

LIGHT DUTY ASPHALT
N.T.S.

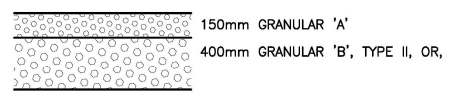

GRAVEL DRIVE/PARKING
N.T.S.

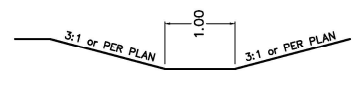

FLAT BOTTOM SWALE DETAIL
N.T.S.

OPSS SPECIFICATIONS

THE MUNICIPAL-ORIENTED ONTARIO PROVINCIAL STANDARDS IN AFFECT WHEN THE CALL FOR TENDERS FOR THIS CONTRACT WAS ADVERTISED SHALL APPLY FOR THE DURATION OF THE CONTRACT. ALL REFERENCES WITHIN THIS SPECIFICATION TO AN OPSS SHALL BE DEEMED TO MEAN OPSS.MUNI, UNLESS USE OF A PROVINCIAL-ORIENTED SPECIFICATION IS SPECIFIED IN THESE CONTRACT DOCUMENTS. WHEN THERE IS NOT A CORRESPONDING MUNICIPAL-ORIENTED SPECIFICATION, THE REFERENCES BELOW SHALL BE CONSIDERED TO BE THE OPSS LISTED, UNLESS USE OF A PROVINCIAL-ORIENTED SPECIFICATION IS SPECIFIED IN THESE CONTRACT DOCUMENTS.

THE FOLLOWING ONTARIO PROVINCIAL STANDARD SPECIFICATIONS APPLY TO AND FORM PART OF THIS CONTRACT:

102	MUNI 120	127
128	MUNI 180	201
MUNI 206	MUNI 212	310
MUNI 314	351	MUNI 353
MUNI 355	MUNI 401	MUNI 402
MUNI 403	405	407
408	MUNI 410	MUNI 441
MUNI 442	490	MUNI 501
506	MUNI 510	MUNI 517
MUNI 518	MUNI 539	MUNI 706
802	803	MUNI 804
1001	MUNI 1002	MUNI 1003
MUNI 1004	MUNI 1010	MUNI 1101
MUNI 1102	1150	1301
1302	MUNI 1303	1305
1306	1308	1312
MUNI 1315	MUNI 1820	1841
1850	2501	

ONTARIO PROVINCIAL STANDARD SPECIFICATIONS (OPSS) AND ONTARIO PROVINCIAL STANDARD DRAWINGS (OPSD) FORM PART OF THIS CONTRACT. THE TEXT OF ALL OPSS'S IS CONTAINED IN THE MANUAL "ONTARIO PROVINCIAL STANDARD SPECIFICATIONS." THE OPSD'S ARE CONTAINED IN THE MANUAL OF ONTARIO PROVINCIAL STANDARD DRAWINGS.

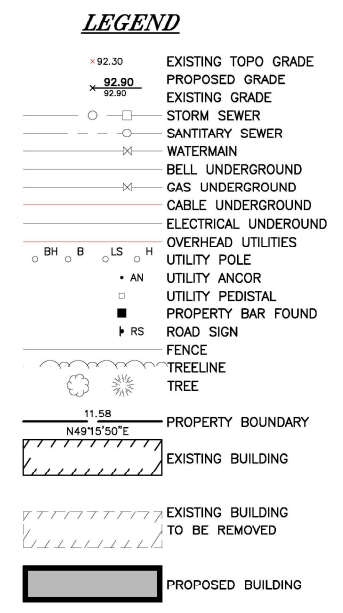

GENERAL NOTES

- ALL WORK ON CITY PROPERTY TO BE PERFORMED BY A CONTRACTOR APPROVED BY THE CITY.
- CONTRACTOR TO VERIFY ALL DIMENSIONS AND ELEVATIONS PRIOR TO THE START OF CONSTRUCTION.
- CONTRACTOR TO OBTAIN ALL NECESSARY PERMITS PRIOR TO START OF CONSTRUCTION.

NOTES: EROSION & SEDIMENT CONTROL

- IN ACCORDANCE WITH BEST MANAGEMENT PRACTICES FOR EROSION & SEDIMENT CONTROL:
 - GEOTEXTILE CATCHES SHALL BE INSTALLED UNDER THE LIDS OF ALL EXISTING AND PROPOSED SITE STRUCTURES AND ADJACENT MUNICIPAL STRUCTURES. "ULTRA DRAIN GUARD" OR EQUAL.
 - LIGHT DUTY SILT FENCE AND STRAW BALE CHECKS SHALL BE INSTALLED AT LOCATIONS AS SHOWN ON THE DRAWING.
 - ALL SEDIMENT AND EROSION CONTROL MEASURES SHALL BE INSPECTED DAILY AND AFTER EVERY RAIN EVENT BY THE CONTRACTOR. ALL SEDIMENT AND EROSION MEASURES SHALL BE MAINTAINED, REPAIRED OR REPLACED AS REQUIRED UNTIL CONSTRUCTION IS COMPLETE AND GROUND COVER HAS STABILIZED. THE CONTRACTOR SHALL IMMEDIATELY CONTAIN AND REMOVE ANY SEDIMENTS THAT BREACH SILT BARRIERS.
 - CONSTRUCTION TRUCKS SHALL NOT BE CLEANED OR WASHED OFF ON THIS SITE EXCEPT AT AN APPROVED WASH OFF STATION. ANY FUEL SPILLS SHALL BE CONTAINED & CLEANED UP IMMEDIATELY. THE MINISTRY OF THE ENVIRONMENT MUST BE NOTIFIED IMMEDIATELY IF A SPILL OCCURS.
 - IN THE EVENT THAT THE EROSION AND SEDIMENT CONTROL ("ESC") MEASURE INDICATED ON THIS PLAN ARE NOT SUFFICIENT, THE CONTRACTOR SHALL PROVIDE ADDITIONAL "ESC" MEASURED TO MINIMIZE THE RELEASE OF SOILS AND SEDIMENT INTO BODIES OF WATER AND SEWERS.
 - CONTRACTOR IS RESPONSIBLE FOR REMOVAL OF EROSION CONTROL MEASURES UPON COMPLETION OF CONSTRUCTION AND RE-VEGETATION HAS OCCURRED.
 - CONTRACTOR IS RESPONSIBLE FOR DISPOSAL OF COLLECTED SEDIMENT.
 - THIS DOCUMENT IS TO BE CONSIDERED A LIVING DOCUMENT AND MAY BE AMENDED IF WARRANTED BY CONDITIONS.

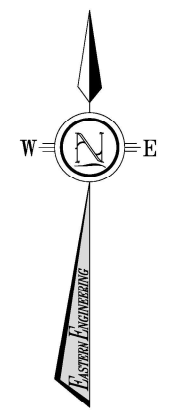

BENCHMARK

NOTE:
CONTRACTOR TO CONTACT UTILITY COMPANIES TO DETERMINE TYPE, LOCATION, AND CONFIGURATION OF EXISTING PLANT.

No.	By	Date	Revisions

All drawings, specifications and related documents are the copyright property of the Engineer and must be returned upon request. Reproduction of drawings, specifications, and related documents in part or whole is forbidden without the Engineers' written permission.

The contractor must check and verify all dimensions on the job prior to start of construction.
Drawings are not to be scaled.

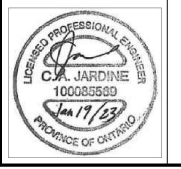

EASTERN ENGINEERING GROUP INC.
CONSULTING ENGINEERS

Apex Building Telephone: (613) 345-0400
207 - 100 Strowger Blvd. Fax: (613) 345-0008
Brockville, Ont. K6V 5J9 www.EastEng.com

PECK'S MARINA BOAT STORAGE

DETAILS

Design: HS	Checked: CAJ	Approved: CAJ	Project No.: 10055
Drawn: HS	Checked: CAJ	Date: 2023-01-23	Contract No.:

Scale: Horizontal: 400

C2

File No.: 10055 C.dwg